



Case History[©]

Work Summary (Site History)

CHS-0043 (BTEX & TPH)

The origin of the contamination problem was from hydrocarbon fuel releases that occurred at a former service station located on the northeast quadrant of the intersection. The service station had been demolished, and some contaminated soil excavation completed. However, high concentrations of contaminants located in monitoring wells indicated that sources still remained in the initial release area. Additionally, similar high concentrations of contaminants in monitoring wells located southeast of the intersection indicated that contaminants were probably transported by the groundwater (flowing in a southerly direction). It was also concluded that the contaminant plume extended from these southerly monitoring points back north, under the road, to the initial source (the former service station). The goal was to treat around the highest contaminated well (MW-7) on the southeast corner of the intersection.

Project at a Glance

Site 0043 - Site Information	
Type of site	Former Service Station
Location	Southern California
Contaminants	BTEX, MTBE, TBA and TPHg
Work Scope	Inject Cool-Ox® Reagent
Media Treated	Soil & Groundwater
Soil Type	High desert, loamy sand
Groundwater Depth	24 ft-bgs
Remedial Objectives	Reduce concentrations and close site
Site 0043 - Application Information	
Technology Selected	Cool-Ox® Process
Application Method	Direct Push Technology (DPT)
Area Treated	1,250 square feet
Vertical Interval	17 to 27 ft-bgs
Injection Point (IP) Spacing	7 feet
Media Volume Treated	463 cubic yards
Number of Injection Points	27
Cool-Ox®	3,240 gal
Cool-Ox® per IP	120 gal

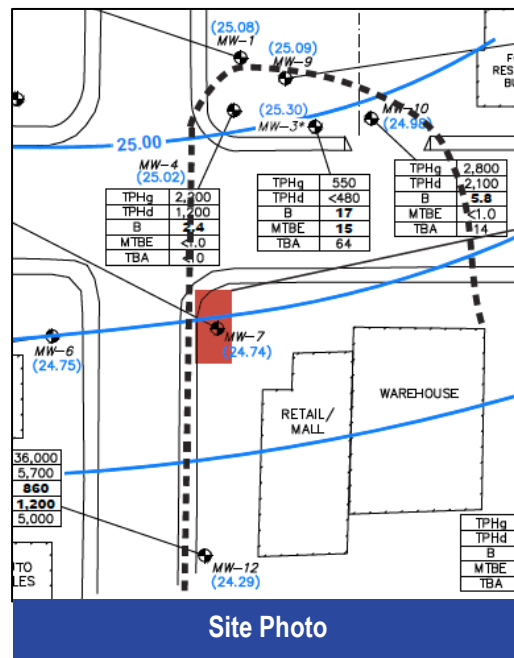

Site Photo



Results

Case History[©]

CHS-0043 (BTEX & TPH) (cont'd)

Well ID	Date	Benzene	Toluene	Ethylbenzene	Total Xylenes	MTBE
		EPA Method 8260B				
		1	150	300	1,750	13
MW-7	05/23/14	5,400	180	1,800	800	300
MW-7	11/17/14	4,000	160	1,600	700	300
MW-7	05/18/15	4,600	160	1,800	770	410
MW-7	06/23/15	4,600	150	1,700	690	370
MW-7	12/04/15	3,500	120	1,400	340	280
MW-7	01/28/16	3,800	150	1,500	560	340
MW-7	04/18/16	510	60	1,300	770	94
MW-7	05/04/16	420	51	1,100	770	120
MW-7	09/01/16	160	31	750	530	110
MW-7	12/04/16	91	25	890	650	67
MW-7	02/02/17	130	3.8	66	68	53
MW-7	05/18/17	<0.50	<0.50	<0.50	<1.0	30

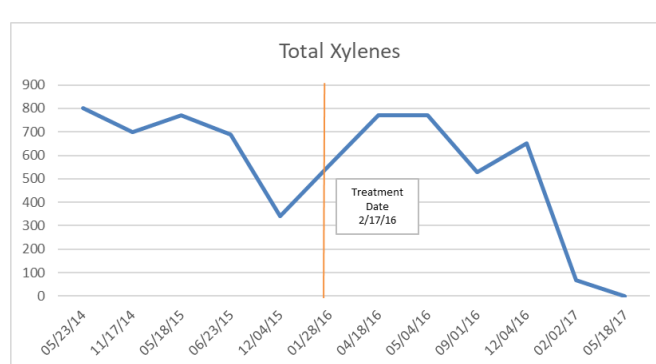
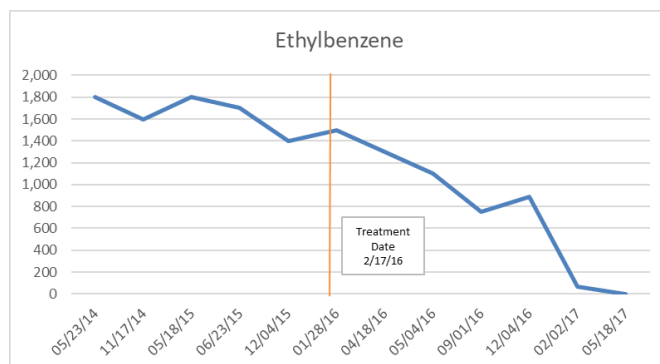
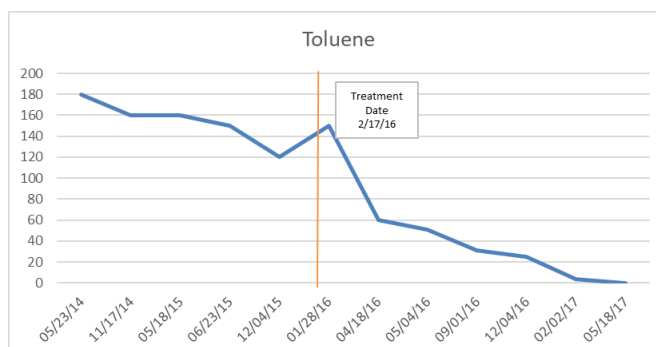
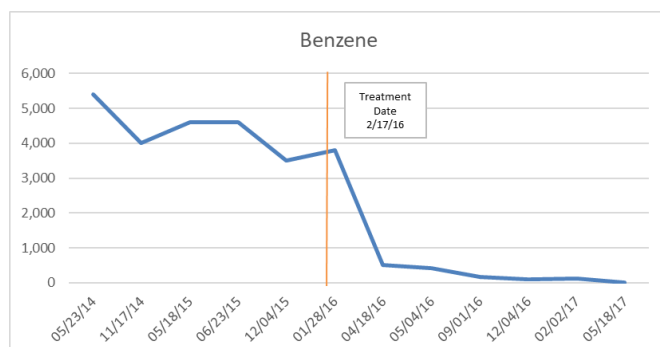



Results

Case History[©]

CHS-0043 (BTEX & TPH) (cont'd)

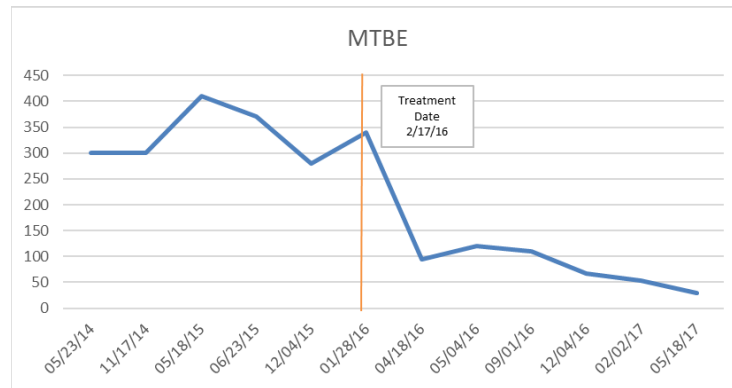

Current Status

Site Closed! – The Los Angeles Regional Water Quality Control Board closed the site because it met the Low-Threat Underground Storage Tank Case Closure Policy.